

# HEREWARD

Community Rail Partnership

## WHITTLESEA STATION MASTERPLAN

A public consultation was held during June and July 2013 where local residents were asked for their views and opinions about the Whittlesea Railway Station Masterplan. The plan set out a vision for the future for Whittlesea Train Station and a final version, taking into account the consultation responses and feedback, was adopted later that year.

### Whittlesea Railway Station Masterplan Map.

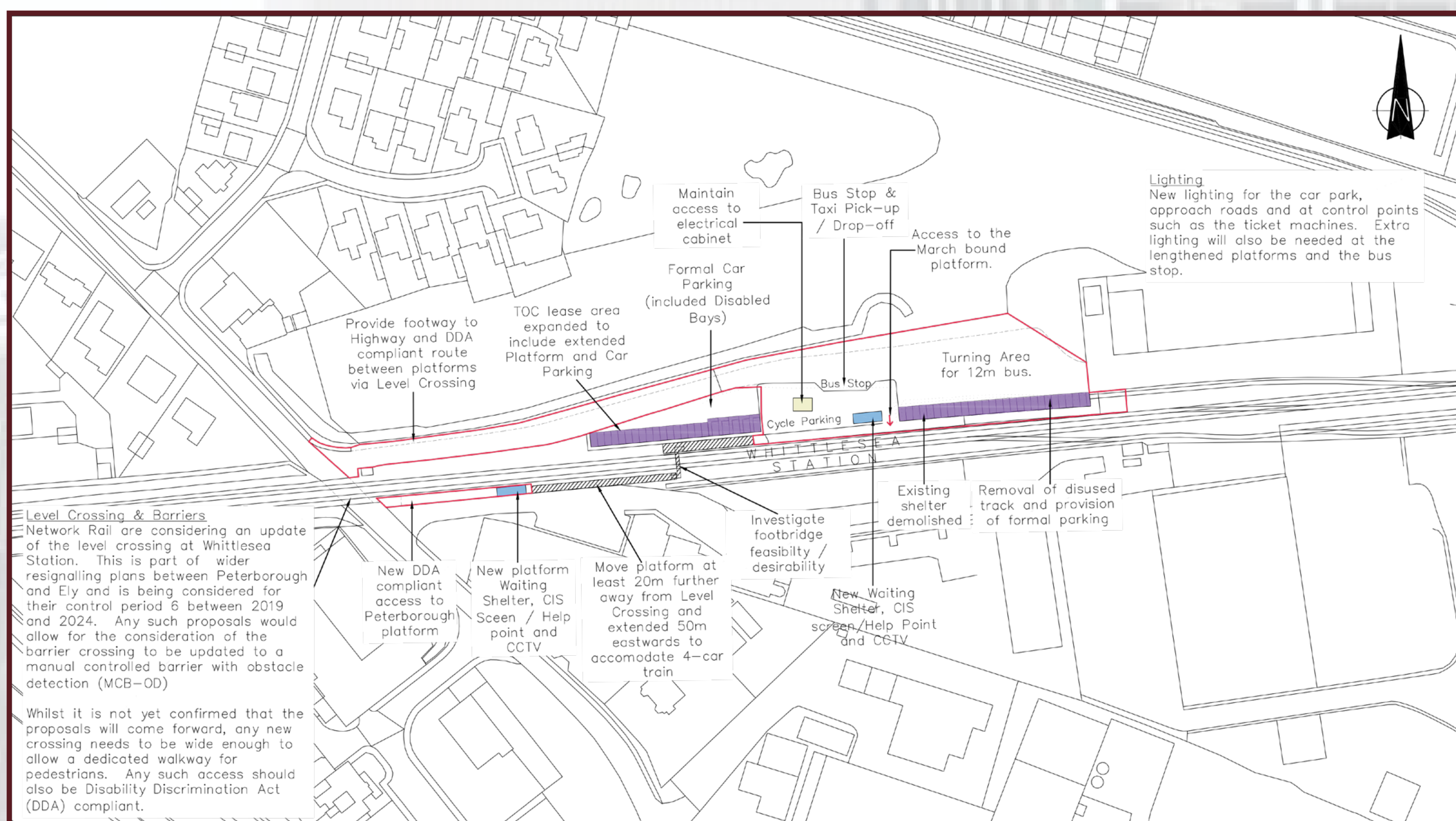

**The masterplan includes proposals to lengthen the platforms and provide a footbridge at Whittlesea Station. An initial feasibility study was undertaken in 2015 followed by completion of Network Rail GRIP states 1 – 3a. This consultation provides more information about these studies and the resulting options to achieve longer platforms and add a new footbridge at Whittlesea to accommodate longer trains and improve access.**